



ELIZABETH HOUSE, E3

£1,700 PER MONTH

- Ground Floor Apartment
- Fully Furnished
- Next to Bromley By Bow Station
- Modern Décor
- Allocated Parking
- Available early August

wj.
meade

Elizabeth House

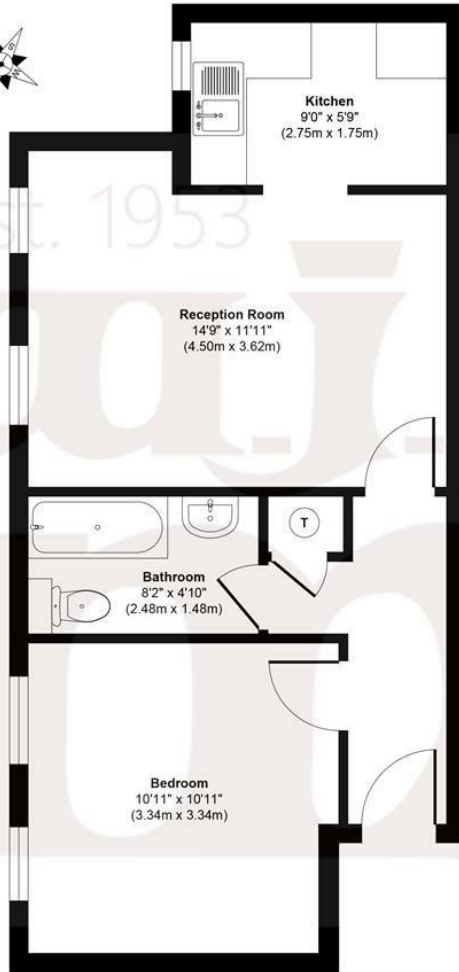

Floor Plan
Approximate Floor Area
438 sq. ft
(40.76 sq. m)

Approx. Gross Internal Floor Area 438 sq. ft / 40.76 sq. m

Illustration for identification purposes only, measurements are approximate, not to scale.
Produced by Elements Property



W J Meade are delighted to offer this great ground floor flat to rent in Elizabeth House, E3. Seconds away from Bromley by bow tube station, this spacious one bedroom flat has modern decor throughout, open plan kitchen lounge and is fully furnished. Ideal for professional couple; close to all local amenities, easy reach to Stratford, Canary Wharf and the City. Great benefit of allocated private parking.

Deposit is 5 week's rent.

Service charge £n/a

Ground rent £n/a

Reserve fund £n/a

n/a years lease

Council tax band C

Current EPC Rating 56

Tenure:



All sizes are approximate. The Agent has not tested any apparatus, equipment, fixtures and fittings, or services and so cannot verify that they are in working order or fit for the purpose. A buyer is advised to obtain verification from their Solicitors or Surveyor. Photographs are for illustration purposes only and may depict items, which are not for sale or included in the sale price. References to tenure of a property are based upon information supplied by the vendor. The agent has not had sight of the title documents, a buyer is advised to obtain verification from their solicitor. Money Laundering Regulations 2003: Intending purchasers will be asked to produce identification, documentation at a later stage and we would ask for your co-operation in order that there will be no delay in agreeing the sale.

These particulars are intended to give a fair description of the property only and are in no way guaranteed, nor do of any contract. They are issued on the express condition that all negotiations are conducted through W.J. Meade Estate Agents. All subject to contract and to being unsold.